

DETAILS

Product Number	CA13509_STRADA-SQ-T2
Family	Strada
Type	Assembly
Color	black
Diameter	25 x 25 mm
Height	8,7 mm
Style	square
Optic Material	PMMA
Holder Material	
Fastening	screw, pin, tape
Status	production ready
ROHS Compliant	Yes
Date Updated	21/09/2016



OPTICAL PROPERTIES

LED	Viewing Angle	Light Beam	Efficiency	cd/lm	Connector
MK-R2	sim: Asymmetric	Asymmetric	-	-	-
MHB-A	sim: Asymmetric	Asymmetric	-	-	-
XHP50	Asymmetric deg	Asymmetric	94 %	0.730	-
XP-L HI	Asymmetric deg	Asymmetric	94 %	1.500	-
LUXEON M/MX	Asymmetric deg	Asymmetric	93 %	0.600	-
LUXEON MZ	Asymmetric deg	Asymmetric	94 %	1.200	-
LUXEON TX	Asymmetric deg	Asymmetric	94 %	1.400	-
LUXEON XR-M linear 1x3, 1x4, 1x5	Asymmetric deg	Asymmetric	94 %	0.940	-
NV4x144A	Asymmetric deg	Asymmetric	94 %	0.700	-
NVSxx19B/NVSxx19C	sim: Asym	Asymmetric	sim: 91 %	-	-

D C B A

4

4

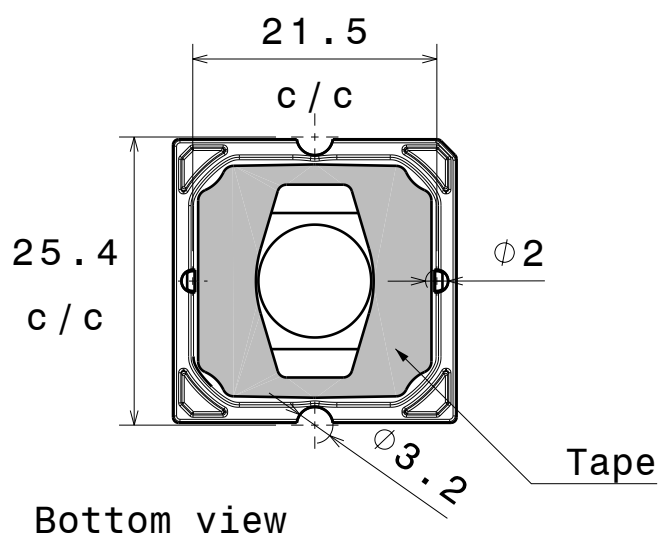

Bottom view

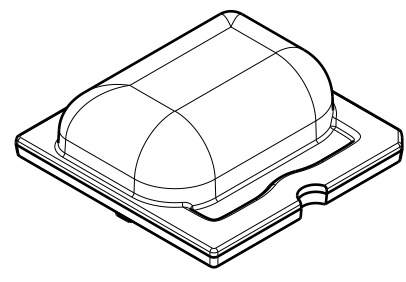

Isometric view

3

3

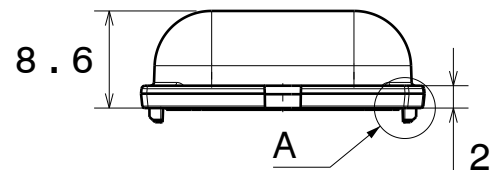

Front view

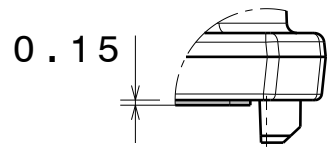

Detail A

2

2

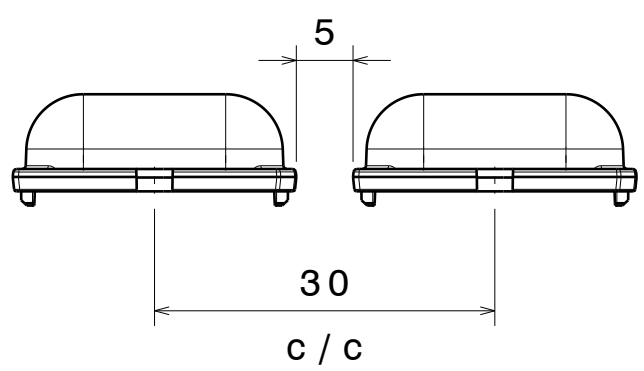

Minimum spacing

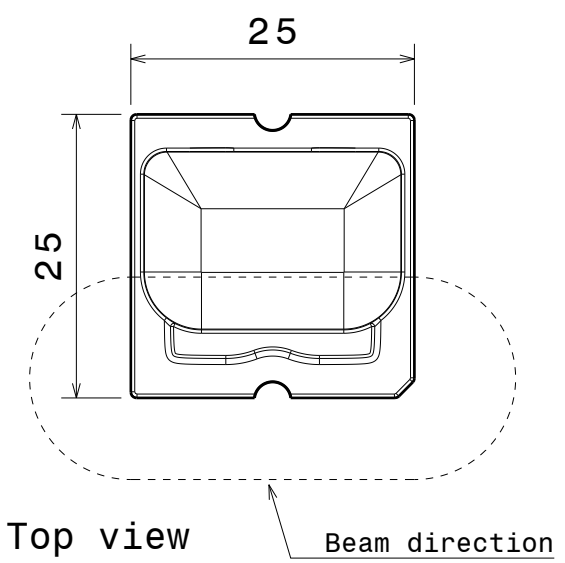

Top view

Tolerances if not otherwise shown
According to DIN ISO 2768-1
Linear measures:
Up to 30mm class M, otherwise class C.
According to DIN ISO 2768-2
Form and position: class L

LEDiL	Ledil Oy		
	Salorankatu 10 FIN 24240 SALO Finland		

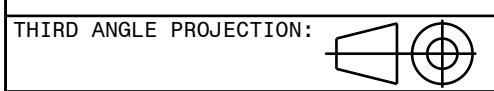

DRAWING TITLE
STRADA-SQ-T2 Datasheet

This drawing is the property of LEDiL Oy. It may not be reproduced, copied or communicated without a written agreement with LEDiL Oy."

SIZE	PART NUMBER
A4	-

SCALE	3:2	WEIGHT	-	SHEET	1/1
-------	-----	--------	---	-------	-----

1

1

D A

Luminaire: LEDiL Oy CA13509_STRADA-SQ-T2_(Cree_XHP50_Cool_White)
Lamps: 1 x Cree_XHP50_Cool_White_244.145lm@250mA_P=1.42855W_η=0.2499A

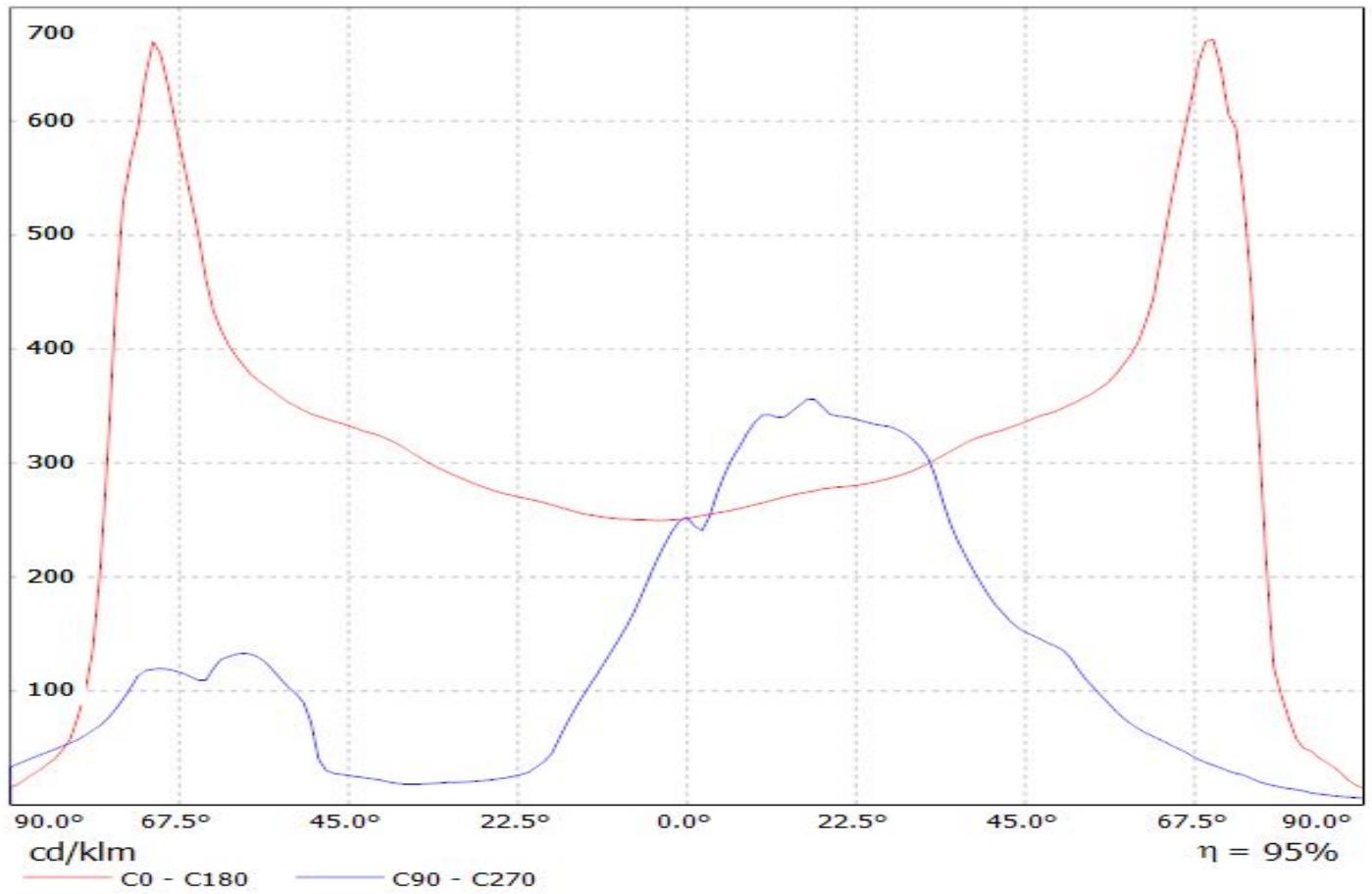

Ledil CA13509_STRADA-SQ-T2_(XP-L_HI) / LDC (Linear)

Luminaire: Ledil CA13509_STRADA-SQ-T2_(XP-L_HI)
Lamps: 1 x CREE_XP-L_HI_116.97lm@250mA_P=0.75W_I=0.25A

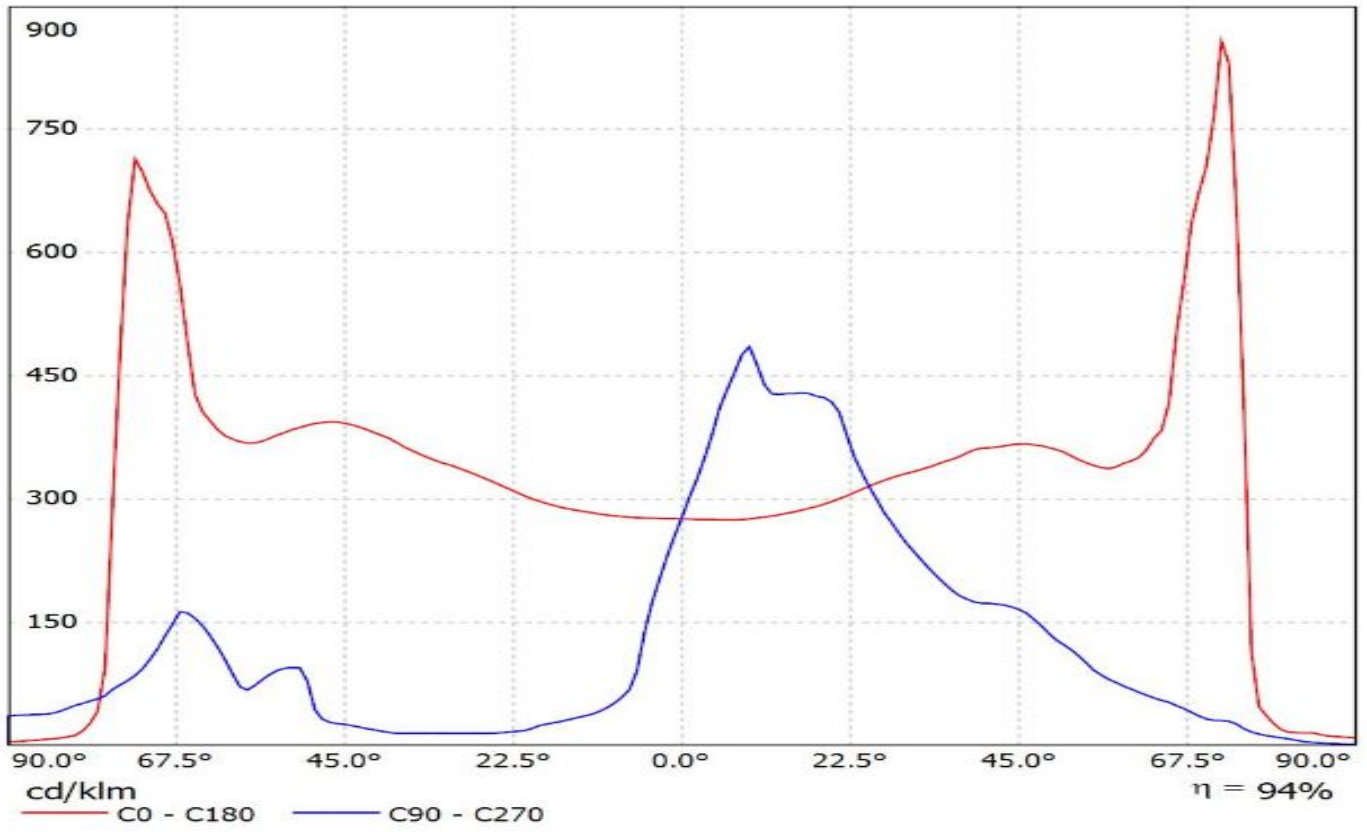

LEDiL Oy CA13509_STRADA-SQ-T2_(LUXEON_M) Eff.93.1% / LDC (Linear)

Luminaire: LEDiL Oy CA13509_STRADA-SQ-T2_(LUXEON_M) Eff.93.1%
Lamps: 1 x LUXEON_M_350.373lm@250mA_CCT=4092K_P=2.73116W_I=249.9mA

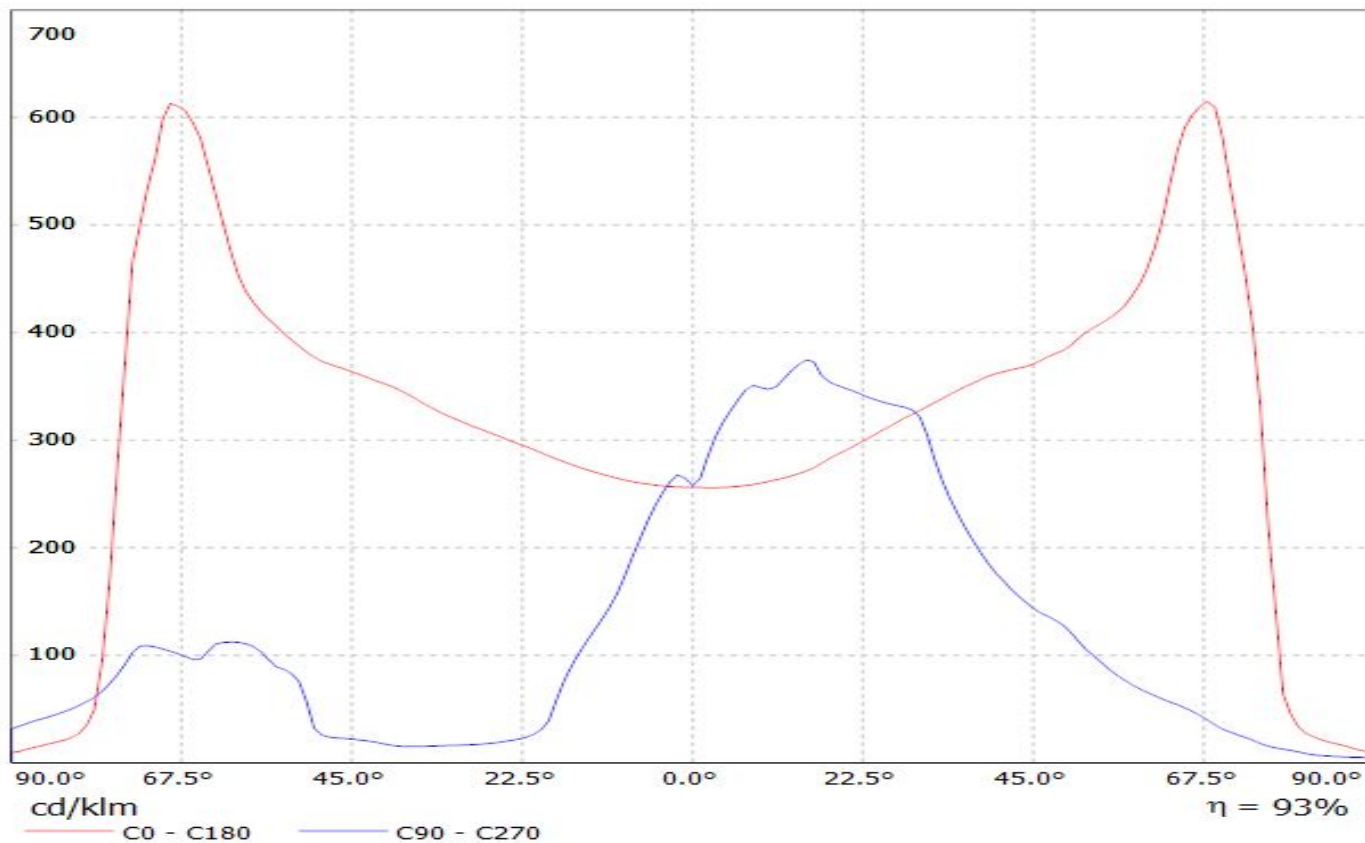

Luminaire: Ledil CA13509_STRADA-SQ-T2_(Luxeon_MZ)

Lamps: 1 x LUXEON_MZ_402.108lm@250mA_CCT=3831K_P=2.8W_I=0.25A

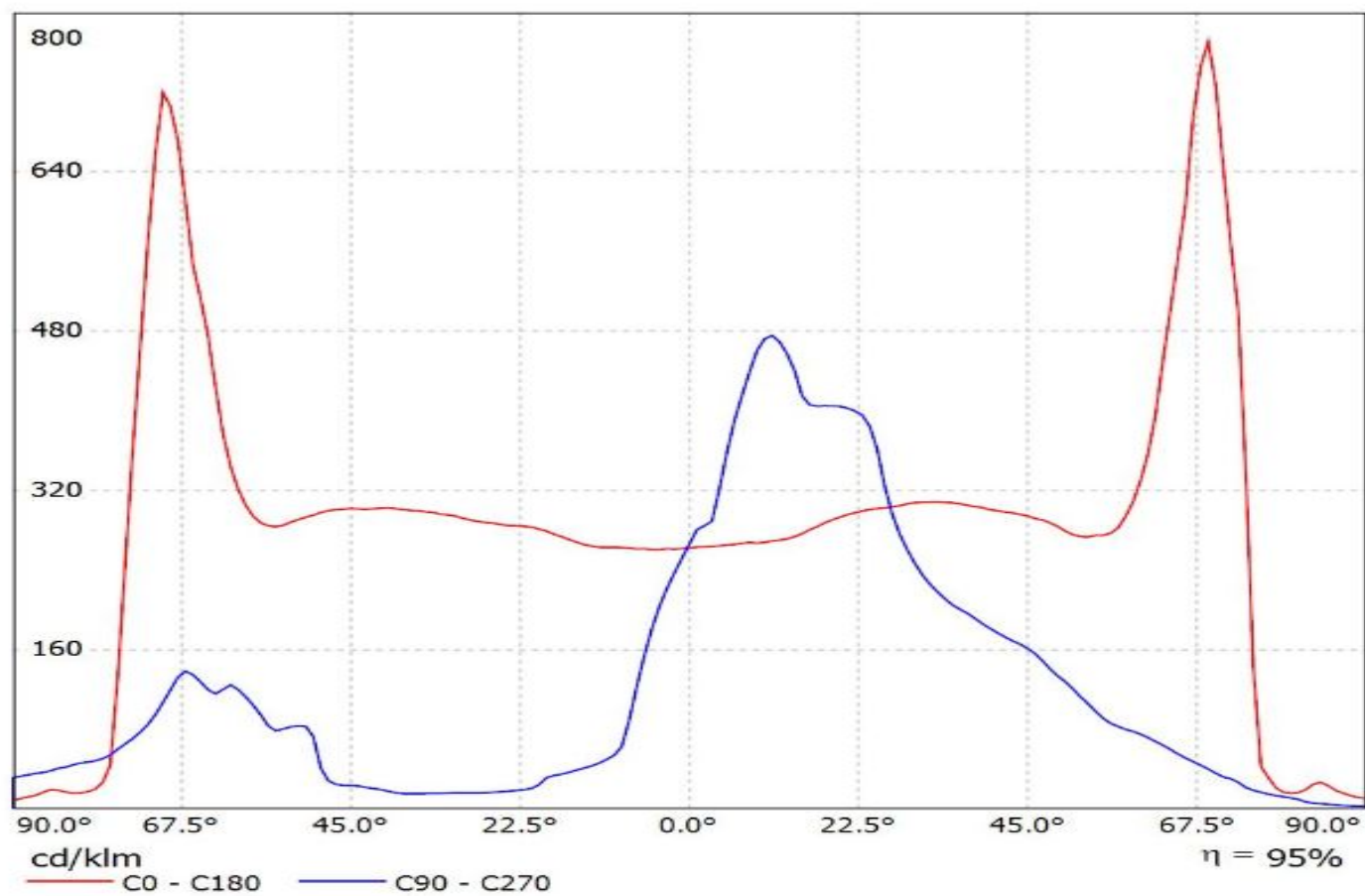

Ledil CA13509_STRADA-SQ-T2_(Luxeon_TX) / LDC (Linear)

Luminaire: Ledil CA13509_STRADA-SQ-T2_(Luxeon_TX)

Lamps: 1 x Luxeon_TX_(L1T2-3585)_83.3206lm@250mA_CCT=3554K_P=0.74W_I=0.25A

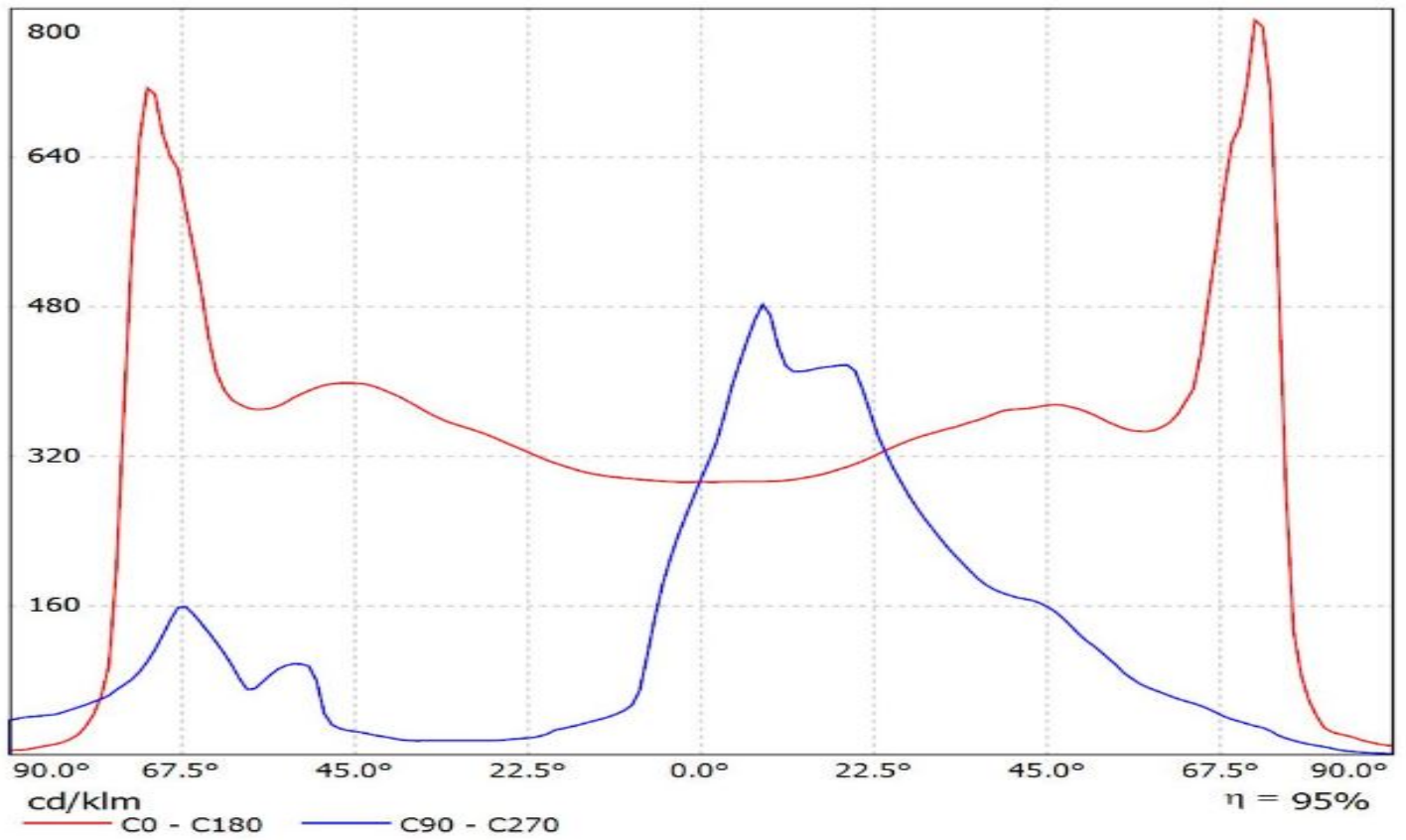

Luminaire: Ledil CA13509_STRADA-SQ-T2 (LUXEON_XR-M_Linear_1x4)
Lamps: 1 x Lumiled_LUXEON_XR-M_Linear_1x4_1798.32lm@250mA_P=11.005W_I=0.25A

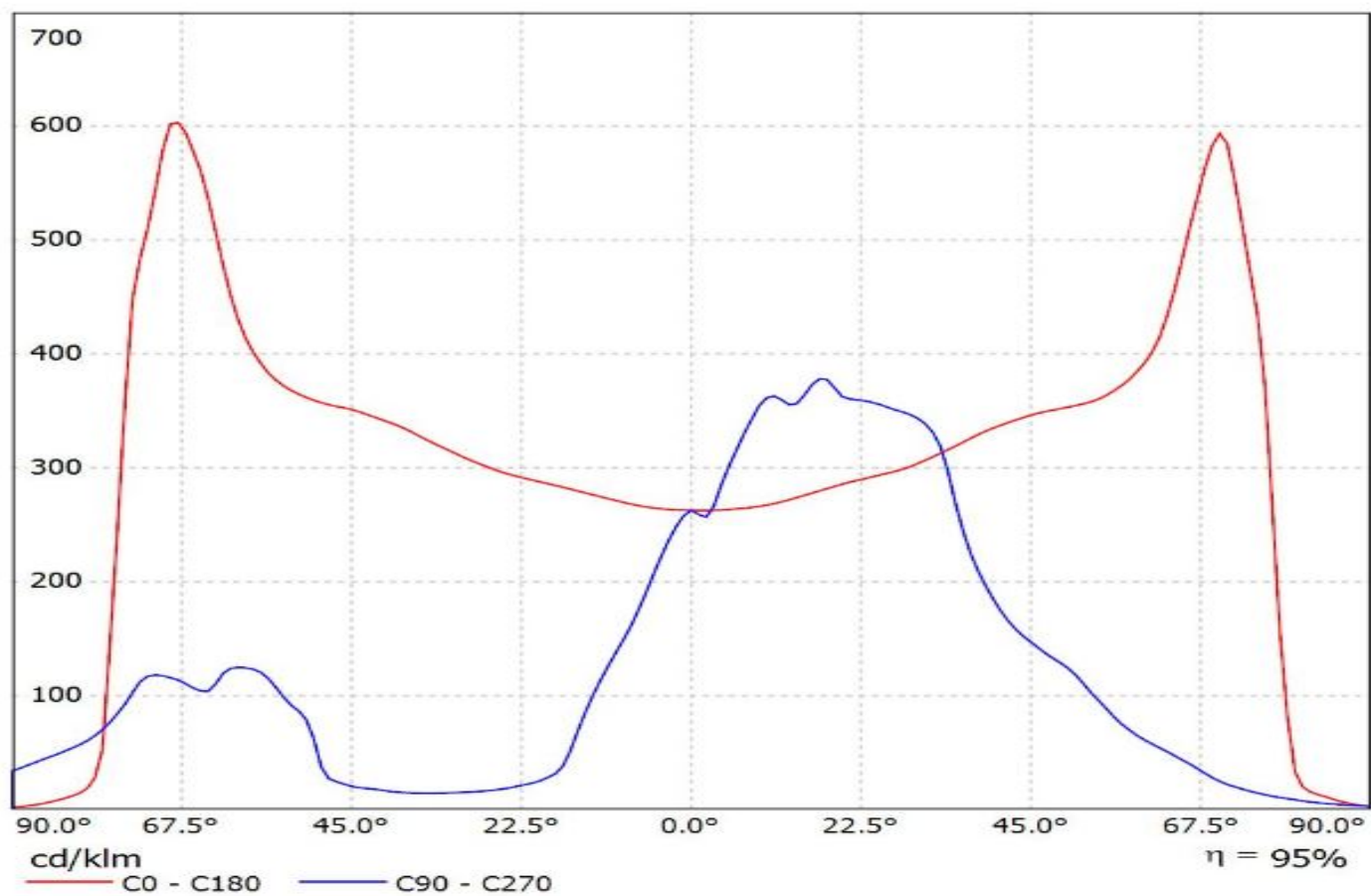

Luminaire: LEDiL Oy CA13509_STRADA-SQ-T2 (NV4x144A)
Lamps: 1 x Nichia_NV4x144A_477.906lm@250mA_P=2.8045W_I=0.250A

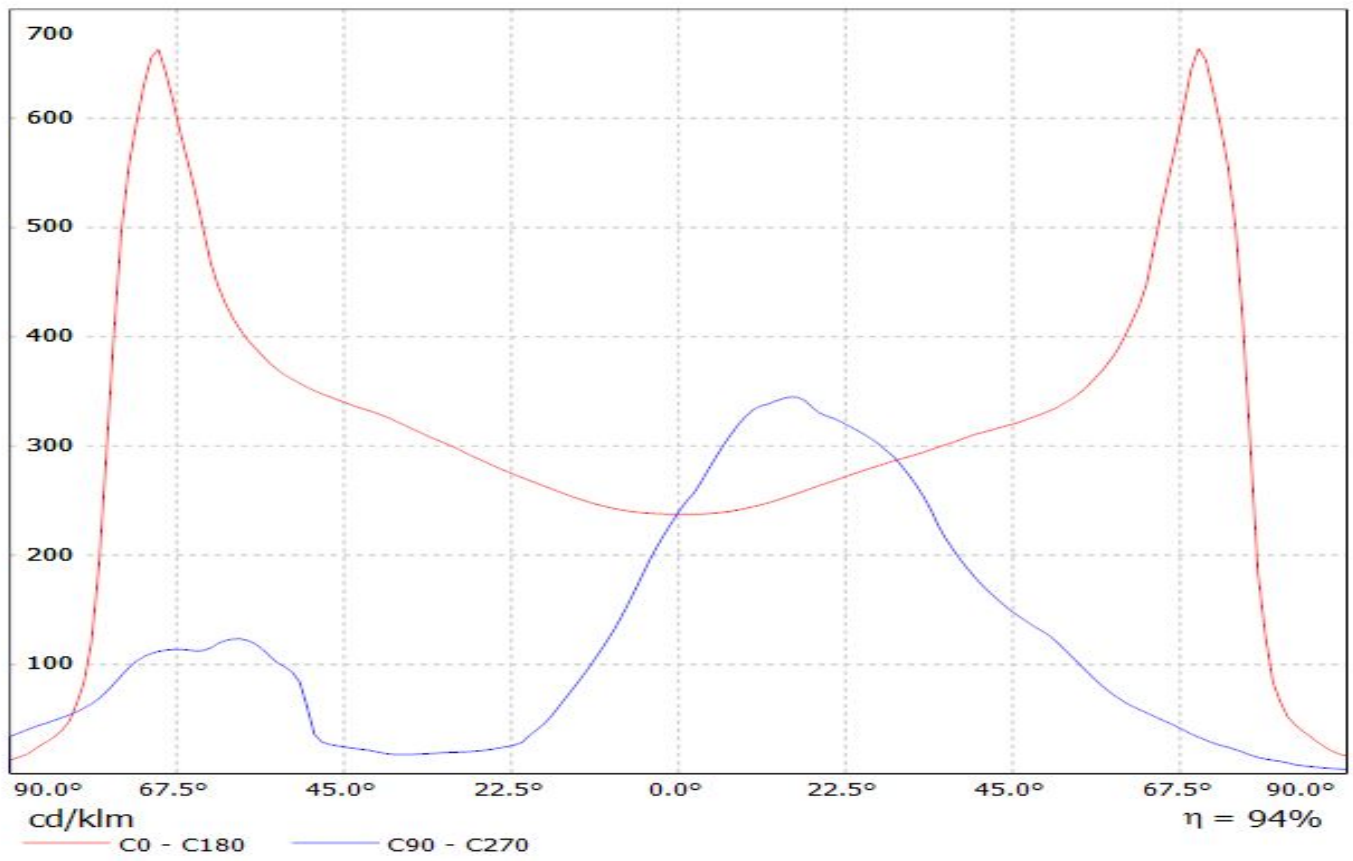

Luminaire: LEDiL Oy CA13509_STRADA-SQ-T2_(Cree_XHP50_Cool_White)
Lamps: 1 x Cree_XHP50_Cool_White_244.145lm@250mA_P=1.42855W_ι=0.2499A

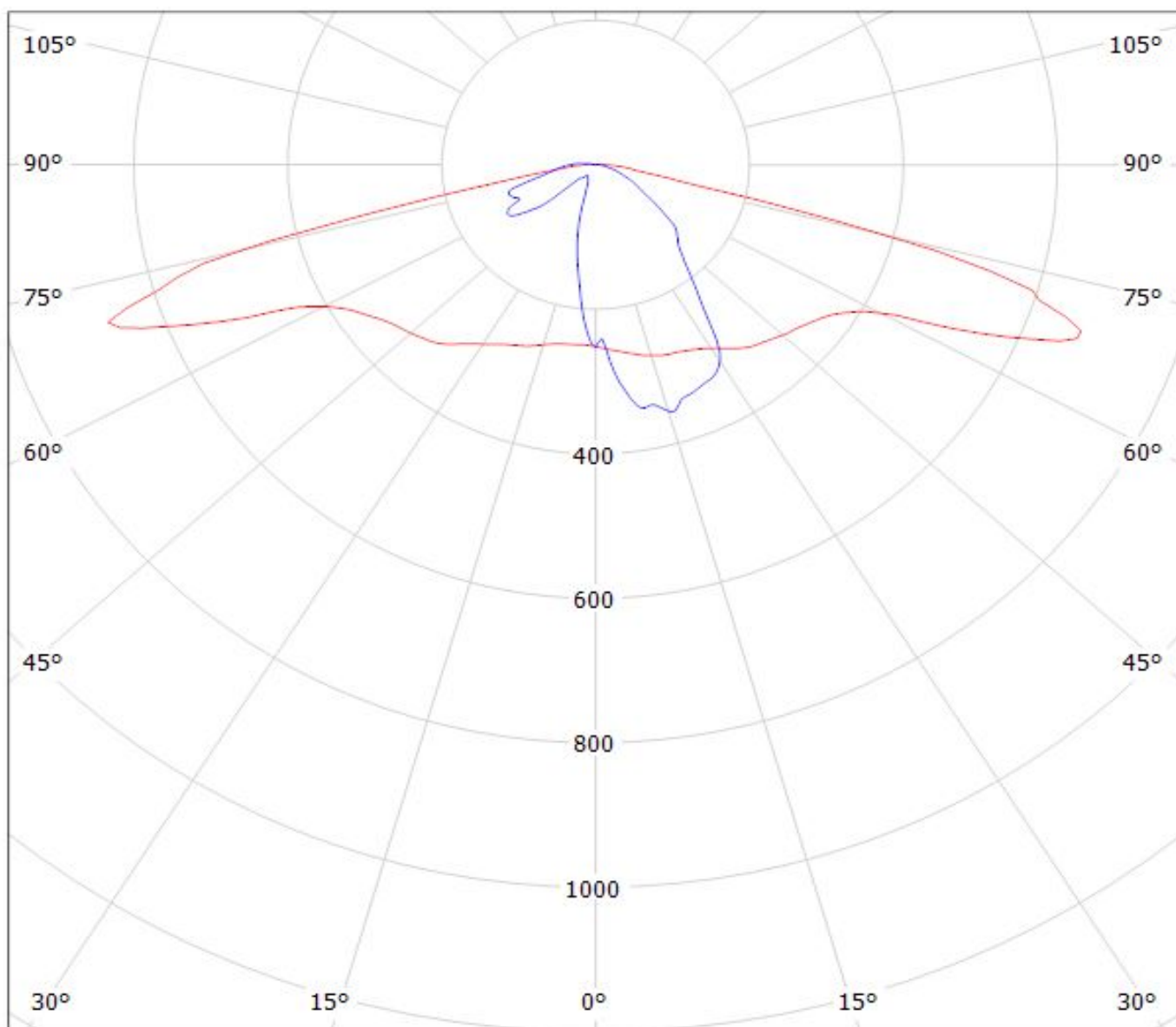

cd/klm

— C0 - C180

— C90 - C270

$\eta = 95\%$

Ledil CA13509_STRADA-SQ-T2_(XP-L_HI) / LDC (Polar)

Luminaire: Ledil CA13509_STRADA-SQ-T2_(XP-L_HI)

Lamps: 1 x CREE_XP-L_HI_116.971lm@250mA_P=0.75W_I=0.25A

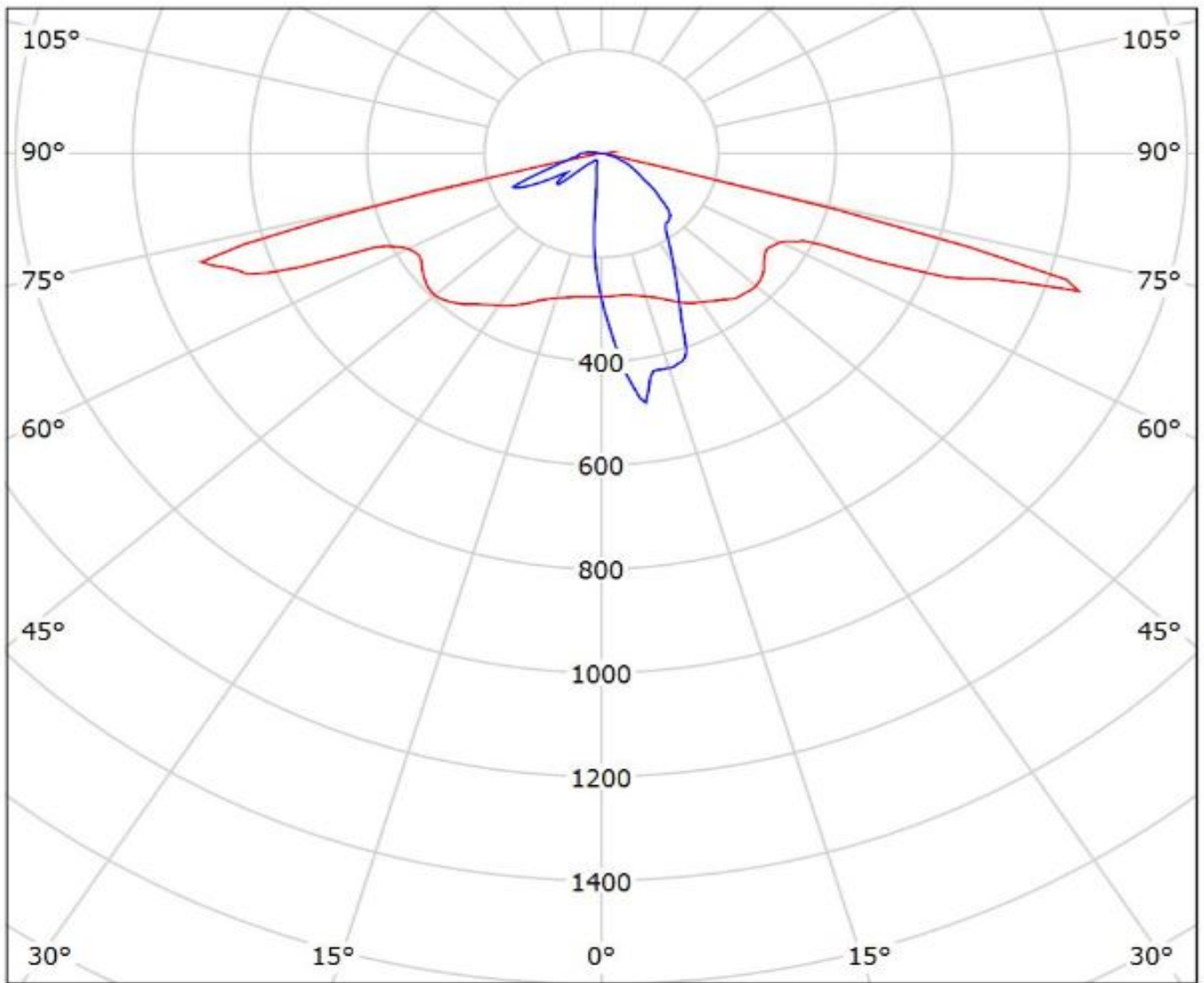

cd/klm

— C0 - C180 — C90 - C270

$\eta = 94\%$

LEDiL Oy CA13509_STRADA-SQ-T2_(LUXEON_M) Eff.93.1% / LDC (Polar)

Luminaire: LEDiL Oy CA13509_STRADA-SQ-T2_(LUXEON_M) Eff.93.1%

Lamps: 1 x LUXEON_M_350.373lm@250mA_CCT=4092K_P=2.73116W_I=249.9mA

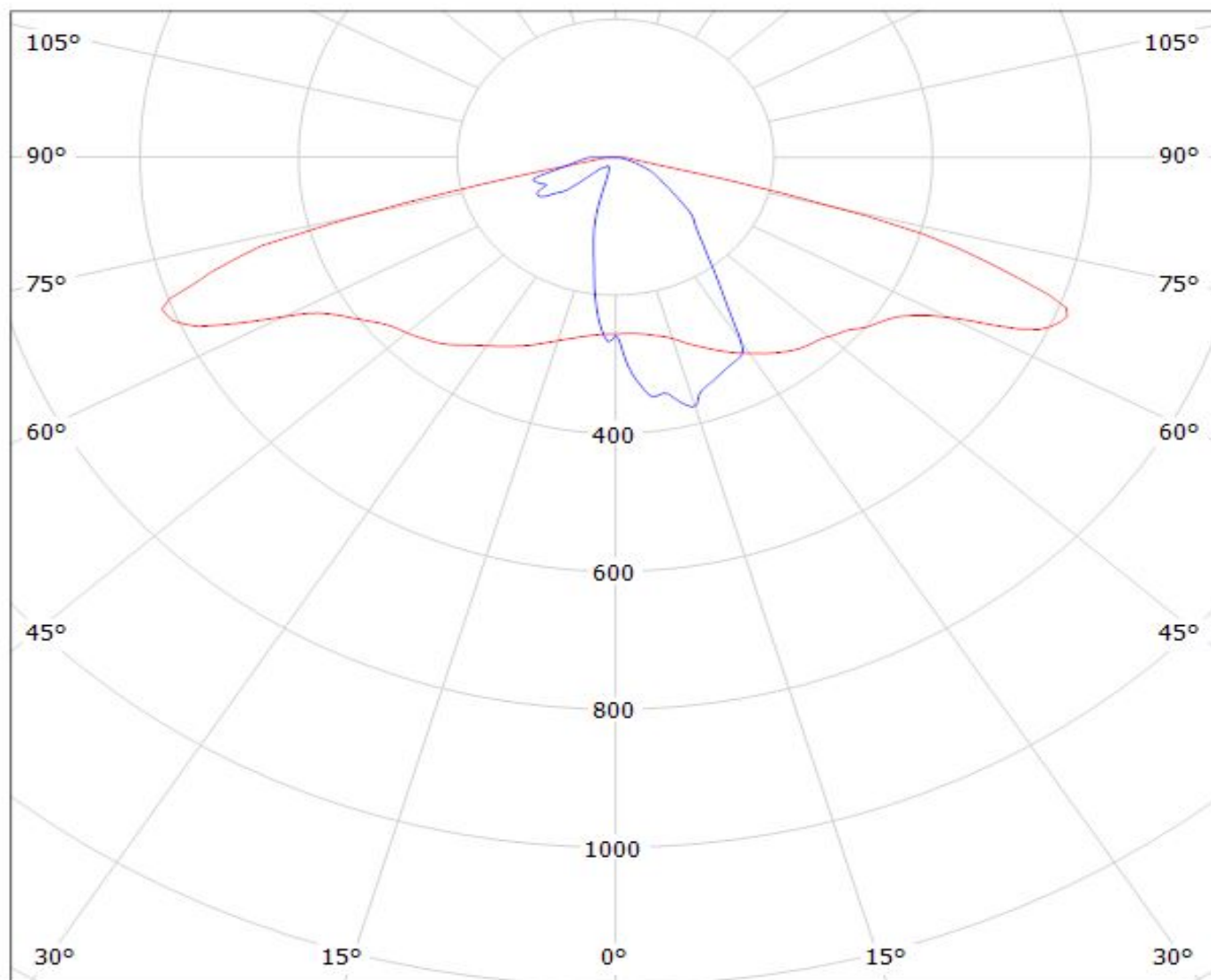

cd/klm

— C0 - C180

— C90 - C270

$\eta = 93\%$

Luminaire: Ledil CA13509_STRADA-SQ-T2_(Luxeon_MZ)

Lamps: 1 x LUXEON_MZ_402.108lm@250mA_CCT=3831K_P=2.8W_I=0.25A

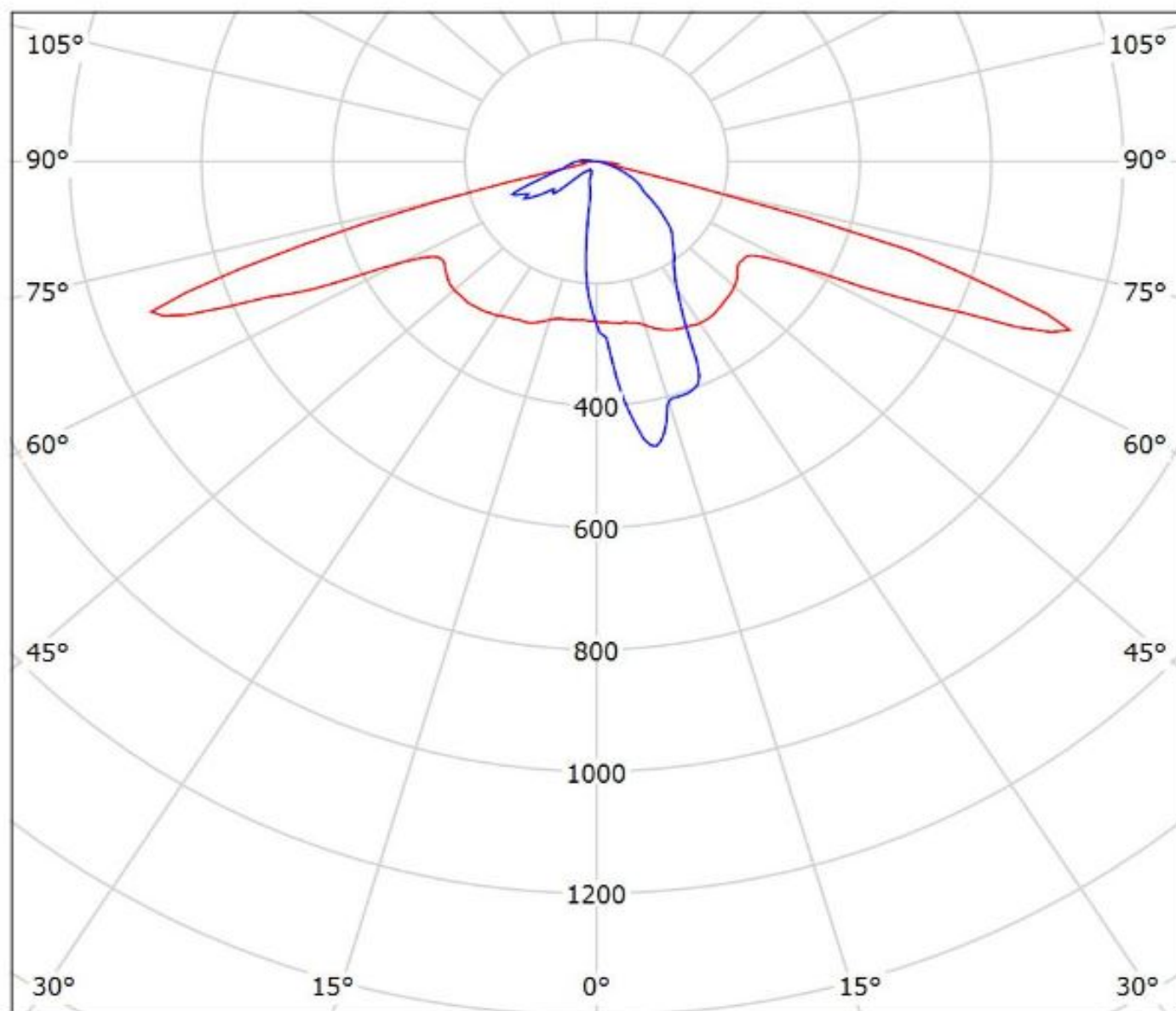

cd/klm

— C0 - C180

— C90 - C270

$\eta = 95\%$

Ledil CA13509_STRADA-SQ-T2_(Luxeon_TX) / LDC (Polar)

Luminaire: Ledil CA13509_STRADA-SQ-T2_(Luxeon_TX)

Lamps: 1 x Luxeon_TX_(L1T2-3585)_83.3206lm@250mA_CCT=3554K_P=0.74W_I=0.25A

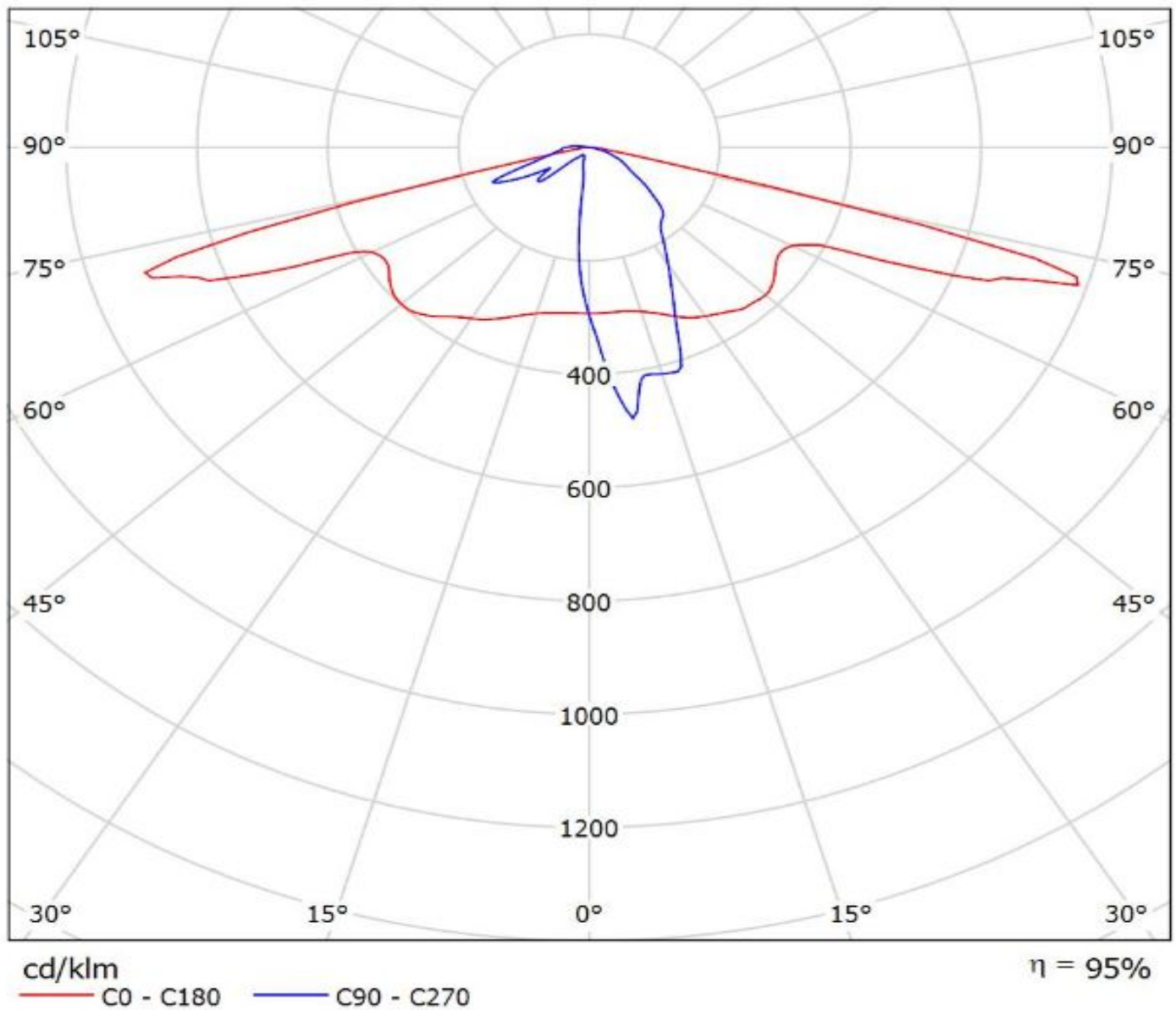

Luminaire: Ledil CA13509_STRADA-SQ-T2_(LUXEON_XR-M_Linear_1x4)

Lamps: 1 x Lumiled_LUXEON_XR-M_Linear_1x4_1798.32lm@250mA_P=11.005W_I=0.25A

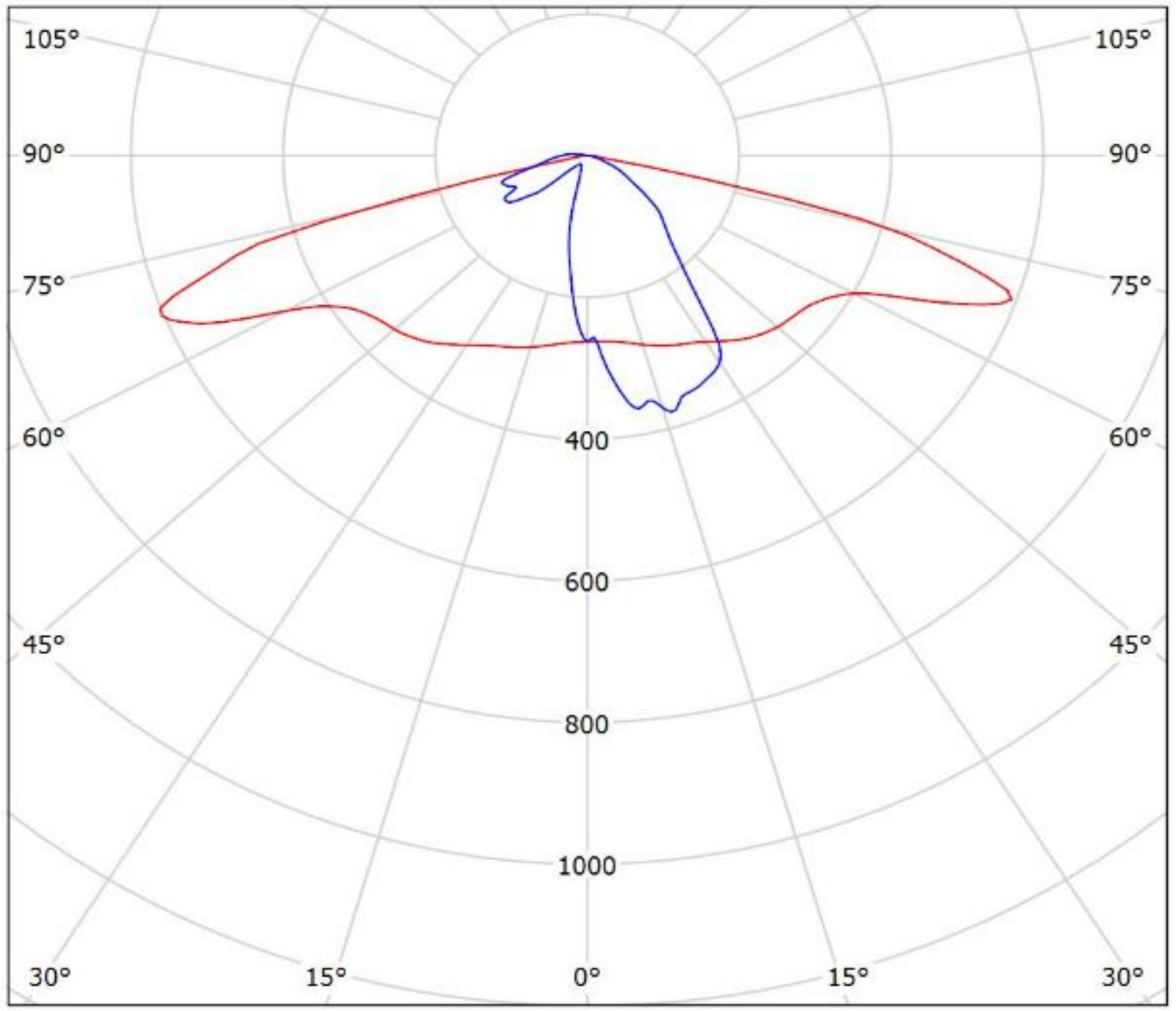

cd/klm

— C0 - C180

— C90 - C270

$\eta = 95\%$

Luminaire: LEDiL Oy CA13509_STRADA-SQ-T2_(NV4x144A)
Lamps: 1 x Nichia_NV4x144A_477.906lm@250mA_P=2.8045W_I=0.250A

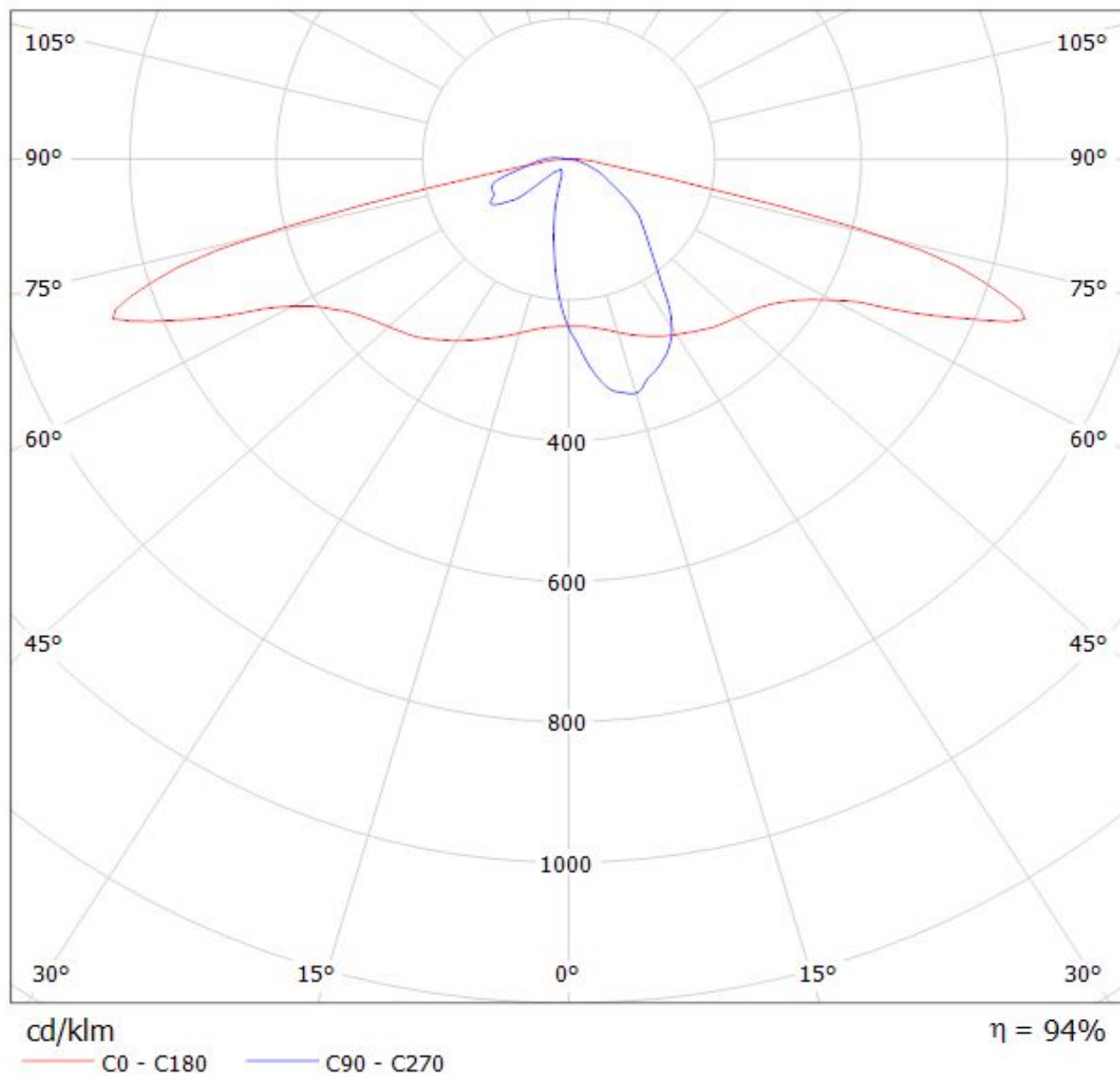

NOTE: The typical divergence will be changed by different color, chip size and chip position tolerance. The typical total divergence is the full angle measured where the luminous intensity is half of the peak value.