

4

3

2

1

THIS DRAWING IS UNPUBLISHED. RELEASED FOR PUBLICATION ,19 .  
 © COPYRIGHT 19 BY AMP INCORPORATED. ALL RIGHTS RESERVED.

LOC	DIST	REVISIONS			
P	LTR	DESCRIPTION	DATE	DWN	APVD
G	14	B	REL PER 0G3A-0614-01	19NOV01	JR TM

**AMP**  
**WIRE RANGE**  
 16-14 AWG  
 STRANDED

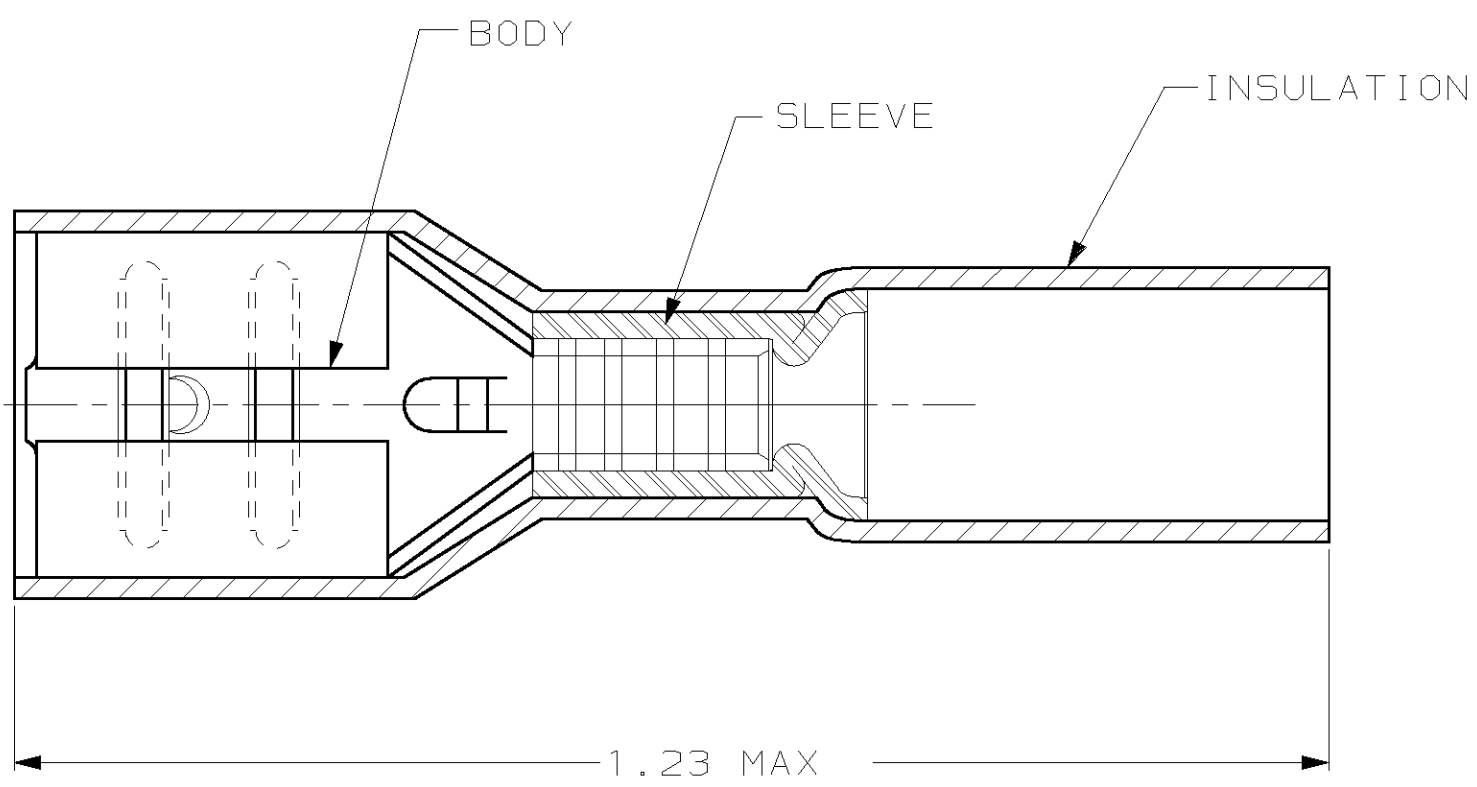

1. INSULATION DIA .200 MAX
2. FITS TAB .032 THK

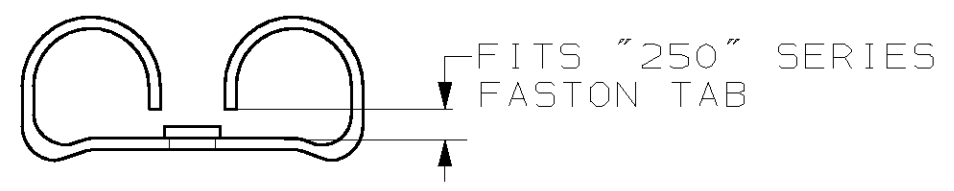

2500	TAPE MOUNTED	2-696304-1
1000	LOOSE PIECE	696304
QTY	PACKAGE TYPE	PART NO

AMP INCORPORATED CUSTOMER SERVICE SYSTEM		MAX RECOMMENDED OPERATING TEMPERATURE: 105° C	THIS DRAWING IS A CONTROLLED DOCUMENT FOR AMP INCORPORATED. IT IS SUBJECT TO CHANGE AND THE CONTROLLING ENGINEERING ORGANIZATION SHOULD BE CONTACTED FOR THE LATEST REVISION.		DWN JR RUTH 31MAY01	<b>AMP</b> AMP Incorporated Harrisburg, PA 17105-3608
FOR ADDITIONAL PRODUCT INFORMATION OR COPIES OF DRAWINGS AND TECHNICAL DOCUMENTS	PRODUCT INFORMATION CENTER 1-800-522-6752	VOLTAGE RATING: 300 V MAX	DIMENSIONS: INCHES	TOLERANCES UNLESS OTHERWISE SPECIFIED: 0 PLC ±- 1 PLC ±- 2 PLC ±.015 3 PLC ±- 4 PLC ±- ANGLES ±-	CHK T MICHIELUTTI 31MAY01 APVD T MICHIELUTTI 31MAY01	
FOR APPLICATION TOOLING INFORMATION	TOOLING ASSISTANCE CENTER 1-800-722-1111	CIRCULAR MIL AREA: 1.04-2.62mm² [2,050-5,180] CIR MILS STRANDED	MATERIAL BODY: BRASS SLEEVE: COPPER INSULATION: POLYOLEFIN UL94-V2	FINISH BODY: TIN PLATE SLEEVE: TIN PLATE	PRODUCT SPEC - APPLICATION SPEC - WEIGHT -	SIZE A3
FOR ORDER ENTRY	1-800-526-5142	CUSTOMER DRAWING		SCALE 6:1	SHEET 1 OF 1	DRAWING NO C-696304 REV B